

# We Take You THERE But We Invest HERE

MARYLAND AVIATION  
ADMINISTRATION

2024  
ANNUAL  
COMMUNITY  
REPORT



# OUR STAKEHOLDERS

Our stakeholders are at the heart of everything we do, guiding our mission to deliver exceptional service and operational excellence. We foster meaningful relationships and align initiatives with their priorities to create shared value and drive sustainable growth.



- **GOVERNMENT**

- Federal
- State
- County
- Local

- **MILITARY**

- **NATIONAL CAPITAL REGION**

- **PASSENGERS**

- **ELECTED OFFICIALS**

- **YOUTH**

- **CITIZENS OF MARYLAND**

- Neighboring Communities
- Community Partners

- **AIRPORT COMMUNITY**

- Airlines
- Tenants
- Employees

- **AVIATION COMMISSION**

- **COMMUNITY ROUNDTABLES**

- DC Metroplex BWI Community Roundtable
- Martin State Airport Community Roundtable

- **NON-PROFITS**

- **BUSINESS COMMUNITY**

- International Businesses
- Trade Associations
- Partner Associations

# TABLE OF CONTENTS

- 2** ▶ Leadership Messages
- 4** ▶ Who We Are
- 6** ▶ Business Highlights
- 9** ▶ Legislative Affairs
- 10** ▶ Diversity, Equity, and Inclusion
- 13** ▶ Five Pillars of Community Support
- 14** ▶ Economic Development
- 16** ▶ Community Engagement
- 24** ▶ Environmental Sustainability
- 28** ▶ Youth Engagement
- 30** ▶ Military Support
- 32** ▶ Financials
- 34** ▶ Financial Summary
- 35** ▶ The MAA Leadership Team
- 36** ▶ The Maryland Aviation Commission
- 37** ▶ Professional Affiliations

# LEADERSHIP MESSAGES

## WES MOORE GOVERNOR



The Moore-Miller administration is advancing a long-range transportation plan to serve Maryland for decades to come. We are making strategic decisions to create a reliable, efficient transportation network that offers economic mobility and equitable access. These deliberate investments will connect Marylanders to life’s opportunities, and each other, while leaving no one behind.

A strong, agile aviation system is a critical component of this long-term transportation vision. BWI Marshall Airport, Martin State Airport, and aviation facilities throughout the state link our residents and businesses to the world, while creating jobs and growing the economy. These airports support our work to make Maryland more competitive by boosting tourism, attracting businesses, and creating jobs. A recent report documented that BWI Marshall generates an economic impact of \$11.3 billion while supporting and creating more than 107,000 jobs throughout the state.

Our airports emerged from the pandemic and are stronger than ever. At BWI Marshall, airline and passenger traffic recently reached new heights, with consecutive all-time monthly records set in the summer of 2024. This performance affirms the strength and success of the market here in Maryland.

I acknowledge and thank our airport staff for their dedication and hard work throughout the year. Our administration is grateful for the continued support of community partners who have been instrumental in the success of the Maryland airport system.

## ARUNA MILLER LT. GOVERNOR



Maryland recognizes the critical role that aviation plays in providing essential services to our state’s residents and communities. Across the Maryland aviation system, our administration is focused on expanding facilities, enhancing services, fostering innovation, and emphasizing sustainability. These advancements will benefit air travel and bring new opportunities for growth and development. This Maryland Aviation Administration report highlights key airport initiatives that drive progress and prosperity for our state.

Beyond BWI Thurgood Marshall Airport, public use airports in Maryland play a pivotal role in driving economic success. Maryland’s regional and local airports produce \$752 million in economic impacts, while supporting 10,225 jobs statewide and generating \$168 million in state and local taxes. Our state’s aviation infrastructure plays a critical role in driving economic growth, connecting communities, and supporting key industries.

I want to thank the MAA staff for providing safe, efficient, and excellent customer service for our passengers, partners, and community members. Maryland’s airports serve important air travel and cargo functions that drive sustained economic growth.

As we continue to invest in our airport infrastructure, we remain committed to supporting and enhancing these critical aviation services. By doing so, we aim to ensure that Maryland’s airports can meet the growing demands of both passengers and businesses.



**PAUL WIEDEFELD MDOT SECRETARY**



Maryland’s diverse economy benefits from access to an outstanding transportation network. The Maryland Department of Transportation delivers facilities and services that are critically important to the quality of life for all state residents, offering daily use for employment, education, health care, and leisure activities. Whether it’s mass transit, highways, or the Port of Baltimore, these MDOT services support access, mobility, and economic development.

Among the multimodal services offered and supported by MDOT, the state is home to a rich system of airports. These aviation facilities range from BWI Thurgood Marshall Airport, an active, large hub airport that serves millions of passengers each year to small airfields that primarily function for personal and recreational aircraft. Maryland’s airports are spread throughout the state, from the mountains of western Maryland to the rural towns and beachside resorts on the Eastern Shore.

MDOT and the Maryland Aviation Administration work to ensure that the air travel needs of Marylanders are met with safety and the highest quality. The Maryland aviation system is crucial to the state’s economic vitality, connectivity, and safety. It supports a wide range of industries, including tourism, healthcare, and agriculture by enabling the efficient transport of goods, services, and people.

Maryland airports enhance the state’s global competitiveness by providing efficient access to national and international markets, while also providing essential infrastructure for local communities. The continued development and maintenance of Maryland’s aviation system is key to fostering economic growth and ensuring the state’s long-term prosperity. We will continue to support our airports and invest in the needed infrastructure and services to ensure they remain safe, competitive, and thriving for years to come.

**RICKY SMITH MAA EXECUTIVE DIRECTOR/CEO**



This annual community report highlights the Maryland Aviation Administration’s commitment to serving local communities and provides a comprehensive overview of operations, financial performance, and key accomplishments for our airports. The Maryland aviation system plays a critical role, serving as aviation gateway to the world and a catalyst for economic growth. The report details many accomplishments throughout 2024 for BWI Thurgood Marshall Airport, Martin State Airport, and emphasizes the MAA’s continued support for public use airports in Maryland.

Our airports support tourism, trade, and business development for the state and the National Capital Region. Beyond these important functions, the MAA strives to be a good neighbor within our local community. This annual report showcases the MAA’s commitment to lead with a true focus on corporate social responsibility. Throughout the year, the MAA made a determined, conscientious effort to further engage with our local community and enhance outreach with our many partners and stakeholders.

The theme of this annual publication, “We take you there, but we invest here,” underscores this level of commitment to serve the public. We have advanced programs across the organization with a particular emphasis on our five pillars: economic development, community engagement, youth engagement, environmental sustainability, and military support. These efforts throughout the year demonstrate leadership and our dedication to maintaining productive relationships with the community for the future. I am confident that BWI Marshall Airport and Martin State Airport will remain sources of pride for our community and valuable transportation assets for our region.

# WHO WE ARE



The Maryland Aviation Administration (MAA) is the owner and operator of Baltimore/Washington International Thurgood Marshall and Martin State Airports. MAA strives to manage these airports to promote growth in the regional economy and to enhance our customers' travel experience. This commitment to performance, excellence, and customer service has led BWI Marshall to become the busiest and most convenient airport in the Baltimore–Washington region. Our responsibility for supporting aviation statewide is met with a commitment to establish a best-in-class aviation system.

## ► MISSION

The MAA fosters the vitality of aviation statewide and promotes safe and efficient operations, economic viability, and environmental stewardship. Responsible for the operation of Baltimore/Washington International Thurgood Marshall and Martin State Airports, the MAA provides friendly, convenient facilities and customer services and develops enhanced domestic and international passenger and cargo opportunities through inter-modalism and state-of-the-art technology.

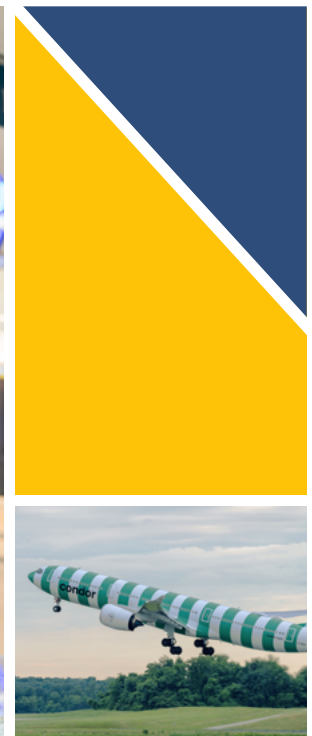





# BUSINESS HIGHLIGHTS



## BWI MARSHALL

remains the **BUSIEST AIRPORT** in the region for both **PASSENGER AND CARGO TRAFFIC**, contributing a total economic impact of



**\$11.3 BILLION ANNUALLY.**

THE AIRPORT OFFERS NEARLY **300 DAILY NONSTOP DEPARTURES** to about **90 DOMESTIC AND INTERNATIONAL DESTINATIONS.**

BWI Marshall & visitors generate & support more than **107,000 JOBS** throughout the region.



**WALL STREET'S RECENT UPGRADES TO THE REVENUE BOND RATINGS THAT SUPPORT THE A/B CONNECTOR AND BAGGAGE HANDLING CONSTRUCTION PROJECT REFLECT THE AIRPORT'S STRONG FINANCIAL POSITION.**



FY24 SET AN **INTERNATIONAL PASSENGER RECORD** as well, with **1.4 MILLION PASSENGERS.**

JULY 2024 WAS THE **BUSIEST MONTH** at BWI Marshall Airport, with a total of **2,667,660 PASSENGERS.**



FY24 SET A NEW FISCAL YEAR RECORD OF **27 MILLION PASSENGERS.**



## NEW AIR SERVICE AT BWI MARSHALL

- **Eighteen new nonstop routes** were introduced throughout 2024, **broadening connections** to additional destinations.
- **BermudAir**, a startup carrier, launched service to **Bermuda** in March.
- **Spirit Airlines** added summer seasonal routes to **Portland, Sacramento, and San Jose.**
- **Southwest Airlines** began **new nonstop service connecting** BWI Marshall with **Colorado Springs, Richmond, VA, and Belize City.**



Water cannons welcomed BermudAir's inaugural flight to BWI Marshall.



▶ **2024 AWARDS**



**LARGE BUSINESS OF THE YEAR AND BUSINESS HALL OF FAME INDUCTION**

BWI MARSHALL AIRPORT  
CENTRAL MARYLAND CHAMBER



**SAFETY HERO AWARD**

STEPHEN SNEAD, SAFETY OFFICER  
MDOT SAFETY COMMISSION



**SAFETY FIRST AWARD**

THE MAA SAFETY MANAGEMENT SYSTEMS COMMITTEE  
MDOT SAFETY COMMISSION



**ANNE ARUNDEL COUNTY CITATION**

SHAWN AMES, DEPUTY DIRECTOR, PLANNING & ENVIRONMENTAL SERVICES  
COUNTY EXECUTIVE STEUART PITTMAN



**BUSINESS HALL OF FAME**

RICKY SMITH, EXECUTIVE DIRECTOR/CEO  
ANNE ARUNDEL COUNTY CHAMBER OF COMMERCE



**JAMES W. ROUSE DIVERSITY AWARD**

THE MARYLAND AVIATION ADMINISTRATION  
CHESAPEAKE HUMAN RESOURCES ASSOCIATION



**OUTSTANDING LEADERSHIP**

ROBERT BOBLITZ, DIRECTOR, AIRPORT SECURITY  
AIRPORTS COUNCIL INTERNATIONAL, NORTH AMERICA



**YOUNG PROFESSIONAL OF THE YEAR**

MATT PETERSON, MANAGER, CORPORATE AND COMMUNITY RELATIONS  
BWI BUSINESS PARTNERSHIP



**PROJECT ACHIEVEMENT AWARD - TRANSPORTATION: CONSTRUCTION VALUE GREATER THAN \$50 MILLION**

BWI MARSHALL AIRPORT – AIRPORT RESTROOM IMPROVEMENTS  
CONSTRUCTION MANAGEMENT ASSOCIATION OF AMERICA

▶ **STATE EMPLOYEES RISK MANAGEMENT (SERMA) AWARDS**

**INJURY REDUCTION AWARD**

The MAA Office of Safety & Risk Management

**BEST PRACTICE AWARD**

The MAA Accident Review Board

**UNsung HERO AWARD**

Harold Fowler, Chief, Martin State Airport

**UNsung HERO AWARD**

Stephen Snead, Safety Officer

**HEALTH & SAFETY WORKING GROUP AWARD**

BWI Marshall Snow Team

**INDIVIDUAL ACHIEVEMENT AWARD**

Shawn Powell, Manager, BWI Maintenance

**EXTRAORDINARY SERVICE AWARD**

Bernadette Bridges, Director, Safety & Risk Management



MAA's Bernadette Bridges (left) receives SERMA's 2024 Extraordinary Service Award.

# BUSINESS HIGHLIGHTS

The MAA Office of Regional Aviation oversees grants for infrastructure improvements at Maryland’s public and private airports. The Airport Improvement Program covers runway, taxiway, and lighting upgrades, with 90% funded by the FAA the remaining 10% shared equally between the State of Maryland (5%) and the airport grantee (5%). In FY2024, 12 airports received grants for 13 projects, totaling \$2.8 million.

In 2024, a new Airfield Lighting Vault (ALV) was completed at BWI Marshall, funded by a \$23 million Federal Aviation Administration grant. The ALV is designed to minimize the risk of an airfield-wide service loss. Its new location, set away from the apron entrance between Concourses B and C, enhances operational efficiency by enabling a dual-taxi entrance to the apron.

## ► FEDERAL FUNDING AWARDS

BWI Marshall and Martin State Airports were awarded nearly \$20 million in federal funding as part of the Bipartisan Infrastructure Law. The funds will support critical infrastructure upgrades, including \$14.5 million for BWI Marshall to replace aging passenger boarding bridges, improving efficiency and safety. Martin State Airport will receive \$5.4 million to replace its air traffic control tower, which has reached the end of its service life, ensuring safer and more efficient operations.

The \$32 million Runway 15-33 Rehabilitation Project at Martin State Airport (MTN) improved infrastructure to enhance safety, efficiency, and sustainability. Approved by the Maryland Board of Public Works in partnership with the Maryland Air National Guard in January 2024, the project ran from April to October and included upgrades to the runway and adjacent taxiways. This investment supports regional connectivity, boosts economic growth, and supports tourism, positioning MTN for future development.



*MAA Executive Director/CEO Ricky Smith signs the Equity in Infrastructure Project Pledge at the 2024 Airport Minority Advisory Council’s Economic Opportunity & Policy Forum.*

# LEGISLATIVE AFFAIRS



The Maryland Aviation Administration (MAA) Government and External Affairs team, led by Chief of Staff Diana Léon Brown, is dedicated to representing the department in legislative matters at both the federal and state levels. Our mission is to engage with Congress, the Maryland General Assembly, and their various committees to address policy, legislation, and other significant issues affecting Maryland aviation. We work diligently to align with the Governor’s legislative priorities, developing and executing strategies that advance these initiatives.

Central to our efforts is fostering strong relationships with elected officials and understanding community needs. By listening to constituents’ priorities, we help facilitate dialogue and shape policies that reflect the diverse interests of the communities we serve.

In 2023, we achieved several key milestones, including hosting over 10 tours and visits for elected officials and stakeholders, successfully organizing our inaugural Annual Legislative Reception, and participating in more than 20 community and stakeholder events. Notably, we supported the passage of HB 573, which



adjusted the membership of the Citizens Committee for the Enhancement of Communities Surrounding Baltimore/Washington International Thurgood Marshall Airport to include representatives from both legislative districts 12A and 12B, ensuring broader community representation.

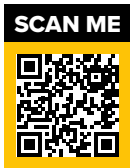

Through these initiatives, the MAA Government and External Affairs team remains committed to strengthening connections between aviation and the Maryland communities we serve.

### [Thriving Communities](#)



Senator Cardin tours BWI Marshall and met with MAA leadership and TSA.

**FOR MORE INFORMATION,  
PLEASE CONTACT**  
**GEORGE R. ROBINSON III**  
ASSISTANT TO THE CHIEF OF STAFF |  
LEGISLATIVE AFFAIRS MANAGER  
**EMAIL:** GROBINSON1@BWIairport.com  
**MOBILE:** 667-967-8097



Senator Cardin receives a security briefing from TSA Federal Security Director, Chris Murgia.



# DIVERSITY, EQUITY, AND INCLUSION

The MAA's dedication to advancing diversity, equity, and inclusion fosters a welcoming environment and serves as a key driver of economic growth for the State of Maryland. By prioritizing initiatives such as the Minority/Disadvantaged Business Enterprise (M/DBE) Program, the MAA plays an active role in the development of small businesses and underrepresented communities. This strategy uplifts disadvantaged communities and strengthens the state's economy in several important ways:



### JOB CREATION

The MAA's investment in local businesses, particularly M/DBEs, directly contributes to job creation and workforce development. As these businesses grow, they hire more employees, boosting employment rates and increasing the local tax base.



### BUSINESS DEVELOPMENT

By leveling the playing field for M/DBEs to compete for contracts, the MAA enables small businesses to access opportunities that might otherwise be out of reach. This promotes innovation and entrepreneurship with the state, because diverse businesses bring fresh ideas and solutions to the market.



### ECONOMIC RESILIENCE

The MAA's focus on fostering a more inclusive and diverse business environment strengthens the state's economic resilience. By supporting a diverse range of businesses across industries, the MAA helps Maryland better navigate economic fluctuations and ensures long-term economic stability.



### PUBLIC SPENDING

The MAA's commitment to equitable contract awards ensures that public spending benefits a wide array of businesses, promoting a fair distribution of wealth across the state. This approach aligns with both federal and state guidelines, maximizing the positive economic impact of public funds and fostering a more balanced economy.

## ► SYNERGYBWI BUSINESS NETWORKING EVENT

An annual event designed to foster economic collaboration between the MAA and local small and minority-owned businesses, **SynergyBWI** creates valuable contracting opportunities in Maryland's aviation industry. The event offers valuable insights into the MAA's procurement process and facilitates networking with prime contractors and government procurement leaders. Participants gain critical knowledge of business certifications, bid preparation, agency forecasts, and upcoming contracting opportunities at BWI Marshall and Martin State Airports. In 2024, the event saw its highest attendance to date, attracting more than 350 business owners and 26 vendors.



*SynergyBWI 2024: Record Attendance!*



► **LAUNCH PAD**

Abrin Fashion House, DifferentRegard Clothing Boutique, Drama MaMa Bookshop, and Pamper Me Please Travel Spa are the latest additions to BWI Marshall’s LaunchPad program. This innovative initiative identifies and supports prospective Airport Concessions Disadvantaged Business Enterprise (ACDBE) operators, providing a valuable opportunity for entrepreneurs to grow their small businesses within BWI Marshall’s vibrant retail environment. By featuring authentic local businesses, the program enhances the passenger experience with a unique taste of the region. LaunchPad participants receive 12-month leases, along with training, sales, and marketing support.



*MAA celebrates the opening of Launch Pad participant, DifferentRegard, with a ribbon-cutting ceremony.*

► **THE HIDDEN DISABILITIES SUNFLOWER**

**This program** is coming to BWI Marshall to make the airport more accessible for passengers with hidden disabilities. Starting in 2025, sunflower-branded items will be available to passengers to discreetly signal to airport staff that a passenger may need additional support or extra time.



**SCAN ME**

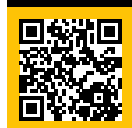

*The Sunflower is for everyone with a hidden disability.*







# FIVE PILLARS OF COMMUNITY SUPPORT

Our airports are more than gateways to distant destinations, they are dedicated partners in strengthening and supporting our community right here at home. Guided by our five pillars—Economic Development, Community Engagement, Youth Engagement, Environmental Sustainability, and Military Support—we focus on initiatives that drive positive change and ensure that our presence benefits Maryland residents in meaningful ways.

Through the Economic Development Pillar, we help stimulate growth in Maryland by creating jobs, supporting local businesses, and positioning the airport as a center for opportunity and commerce. The Community Engagement Pillar reflects our commitment to fostering connections with local organizations and residents, offering resources and services that enhance quality of life. Our Youth Engagement Pillar invests in the next generation, providing educational opportunities and career pathways to inspire young people to get involved in the aviation field. Under the Environmental Sustainability Pillar, we pursue sustainable practices, working to minimize our environmental footprint and contribute to a healthier ecosystem. Finally, through the Military Support Pillar, we partner with military service organizations and communities to honor and support those who serve.

Our slogan, **“WE TAKE YOU THERE, BUT WE INVEST HERE,”** reflects our commitment to creating a brighter, more sustainable future for the communities that live, work, and thrive alongside us.



# ECONOMIC DEVELOPMENT

The MAA fosters the vitality of aviation across Maryland, supporting a network of public-use airports that enhance regional economies and provide essential services. As engines of growth, BWI Marshall and Martin State Airports play a critical role in Maryland’s economic landscape, driving job creation, supporting local businesses, and strengthening commerce. Funded through user fees rather than tax dollars, these airports generate substantial economic benefits through operations, visitor activities, and regional trade. By driving employment, enhancing infrastructure, and connecting Maryland businesses to global markets, BWI Marshall and Martin State Airports serve as pivotal hubs of opportunity and stability.

Additionally, MAA supports regional economic development by providing grants to public-use airports statewide, funding vital infrastructure improvements and projects that increase operational capacity. Through these investments, the MAA ensures that regional airports continue to stimulate local economies, support jobs, and contribute meaningfully to Maryland’s broader economic landscape. The economic impact of aviation is realized by everyone throughout the State of Maryland.

## ► BWI MARSHALL AIRPORT

BWI Marshall Airport serves as a critical economic engine for Maryland, significantly impacting the state’s economy and job market. A recent economic analysis<sup>1</sup> highlights BWI Marshall’s importance in supporting jobs, income, and tax revenues, reinforcing its role as a key transportation hub and economic driver. In summary, the airport’s contributions form a cornerstone for the region’s economic growth and stability.

<p>\$\$\$</p> <p>Total Economic Impact: <b>\$11.3 Billion</b></p>	<p>👛</p> <p>Total Jobs Supported: <b>107,066</b></p>	<p>\$\$\$</p> <p>Total Earnings: <b>\$5.6 Billion</b></p>	<p>\$\$\$</p> <p>State and Local Taxes: <b>\$782.5 Million</b></p>	<p>\$\$\$</p> <p>State Taxes: <b>\$441.3 Million</b></p>	<p>\$\$\$</p> <p>Local Taxes: <b>\$341.2 Million</b></p>
---	--	---	--	--	--

### DRIVING REGIONAL ECONOMIC GROWTH: BWI MARSHALL'S IMPACT



#### JOB CREATION

More than 107,000 jobs, both direct and indirect, support aviation, hospitality, retail, and transportation.



#### LOCAL BUSINESS BOOST

Passenger and visitor spending contributes significantly to nearby hotels, restaurants, and retail outlets.



#### TRADE FACILITATION

Handling large cargo volumes, BWI Marshall connects regional businesses to global markets, enhancing trade.



#### TOURISM AND INTERNATIONAL LINKS

Serving 90 destinations, the airport increases tourism and fosters international business ties.

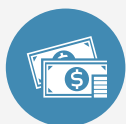

#### INFRASTRUCTURE DEVELOPMENT

BWI Marshall’s growth spurs improvements to regional infrastructure, benefitting businesses and residents.

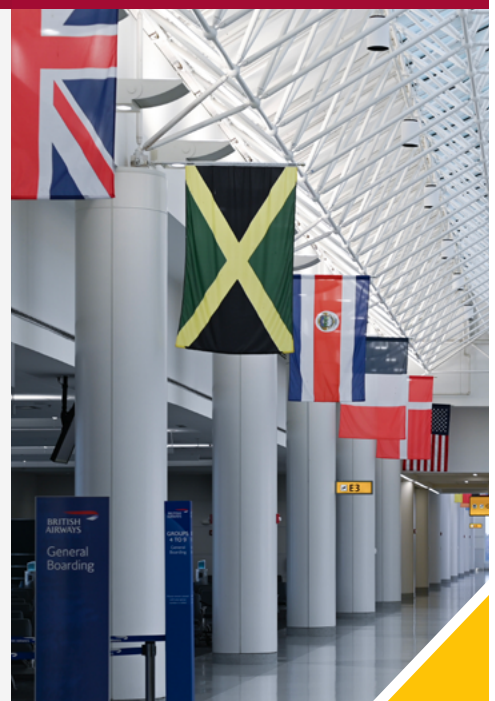



## ▶ MARTIN STATE AIRPORT

**Martin State Airport** also has a substantial economic impact on the Maryland/Washington, D.C. region. According to a 2023 study<sup>2</sup> it supported a total of **2,376 jobs**, consisting of **1,222 direct jobs**, **635 induced jobs**, and **518 indirect jobs**. The airport contributed over **\$200.7 million in personal income**, and it generated approximately **\$342.9 million in business revenue**. Additionally, Martin State Airport produced around **\$48.9 million in state and local tax revenue**.

MTN supports a range of businesses from aviation services to ground transportation, playing a critical role in sustaining the region’s economic vitality.

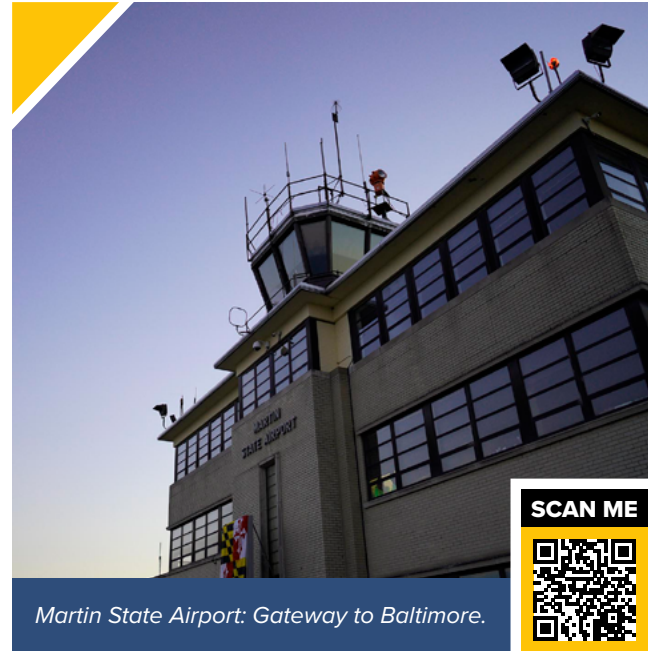

Martin State Airport: Gateway to Baltimore.



MAA Regional Aviation staff at a community engagement event.

## ▶ REGIONAL AVIATION

Maryland’s 33 public-use airports drive economic activity statewide by supporting job creation, business revenue, and overall economic growth. Regional airports are vital to tourism, commerce, and industry, providing essential infrastructure that contributes to Maryland’s prosperity. Notably, a recent study<sup>3</sup> assessed these airports separately from BWI Marshall due to its larger scale and unique impact.

## ▶ KEY HIGHLIGHTS

- **TOTAL ECONOMIC ACTIVITY:** \$1.425 billion generated by Maryland’s public-use airports
- **BUSINESS REVENUE:** Over \$1.107 billion from airport tenants, support services, and visitor services
- **JOB CREATION:** 10,225 jobs linked to the aviation industry

This overview demonstrates how **regional aviation** is vital to the state’s economy, complementing the larger BWI Marshall Airport’s economic impact.

**LOOKING AHEAD**, we’re focusing on infrastructure projects to boost economic resilience.

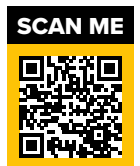

<sup>1</sup> *The Local and Regional Economic Impacts of the Baltimore-Washington International Thurgood Airport, prepared by Martin Associates with Landrum & Brown, Inc.*

<sup>2/3</sup> *The Economic Impact of Public-Use Airports in Maryland, prepared by Martin Associates with Landrum & Brown, Inc.*

# COMMUNITY ENGAGEMENT

The MAA is deeply committed to meaningful engagement with community groups, positioning BWI Marshall and Martin State Airports as valuable partners with our surrounding communities. To foster these connections, the MAA regularly hosts meetings, educational sessions, and tours that create opportunities for businesses, academic institutions, nonprofits, and civic organizations to learn about airport operations and provide valuable input for us. Additionally, our employees are actively engaged in local organizations, interacting directly with community members and being available to address their needs and concerns. By prioritizing transparency, responsiveness, and ongoing dialogue, the MAA strengthens its relationships with local stakeholders and ensures that the airport’s growth aligns with the needs and values of surrounding communities. Below are key initiatives that reflect our dedication to engaging and supporting our community members.

## ► BUSINESS ENGAGEMENT AND INDUSTRY OUTREACH

The MAA is involved in and committed to business and industry outreach to build and sustain mutually beneficial relationships with the business community across Maryland and Washington, D.C., and the broader aviation and transportation industry. The senior leadership team actively serves as members, officers, and volunteers in numerous aviation and transportation organizations, including The Aero Club of Washington, The Airports Council International, The Airport Minority Advisory Council, The American Association of Aviation Executives, The Conference of Minority Transportation Officials, The National Association of State Aviation Officials, and Women’s Transportation Seminar.

In 2024, presentations and tours were organized for the World Trade Center Institute, Leadership Anne Arundel, Moody’s and Fitch ratings agencies, the Defense Information Systems Agency, and attendees of the SelectUSA Investment Summit who were particularly interested in foreign direct investment in Maryland. Additionally, a series of virtual meetings titled “Coffee and Conversation with Ricky Smith” were held to discuss future airport plans with key stakeholder groups.



*The World Trade Center Institute’s Bowes Fellows learned about aviation’s vital role in global business.*



*MAA’s Jordan Kayloe explains how new airline routes are developed with input from businesses in the region.*

## ► YUMI HOGAN ART PROGRAM

BWI Marshall’s [artwork](#), seamlessly integrated into the airport environment, welcomes and inspires passengers through rotating exhibits featuring local institutions and artists. MAA showcases local, regional, and international art, celebrating the area’s natural resources and themes of exploration and aviation. In 2024, the Yumi Hogan Art Gallery featured exhibits curated by the Black Art Today Foundation and Korean-American artists. The Concourse C Gallery is a partnership with the Arts Council of Anne Arundel County and highlights local artists, while the Youth Art Gallery, in collaboration with the Maryland Art Education Association (MAEA), displays student work from across Maryland. These galleries demonstrate BWI Marshall’s dedication to fostering creativity and supporting diverse artistic voices.

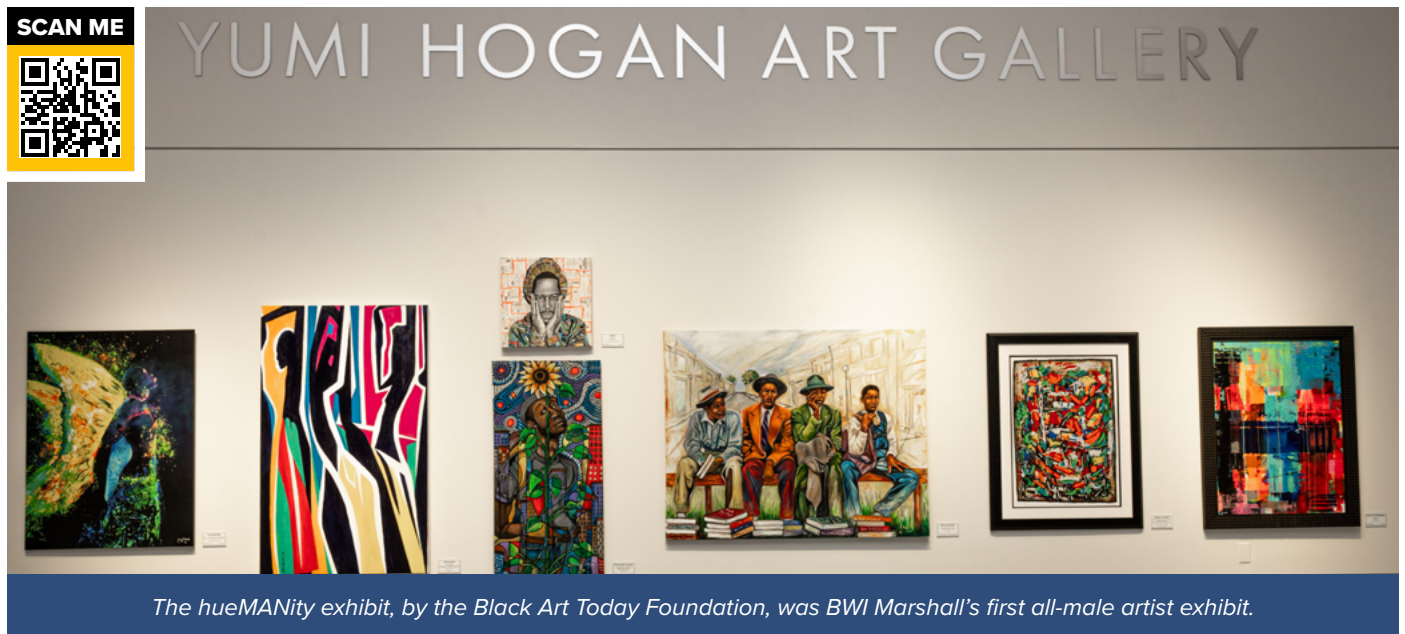

## ► HISTORIC PRESERVATION

The Benson-Hammond House, located on the grounds of BWI Marshall Airport, plays a key role in educating the community about the history of Anne Arundel County. The airport was built on a 3,200-acre farm originally owned by the Hammond family, who lived there until 1947, when the property was acquired for the airport’s construction. In 1975, the Maryland Aviation Administration partnered with the Ann Arrundell Historical Society to restore and maintain the house under a long-term lease.



Today, the [Benson-Hammond House](#) showcases restored 1880s-era outbuildings and Victorian-era artifacts, including period furniture, antique farm tools, textiles, and a notable collection of antique dolls. It serves as a venue for community events and school tours, providing historical education to schoolchildren and the public. These efforts help preserve and share the rich history of the region.



# COMMUNITY ENGAGEMENT



## ▶ HEALTH & WELLNESS

In 2024, BWI Marshall Airport, in partnership with the American Heart Association, introduced a blood pressure kiosk to enhance passenger wellness. This addition complements the Hands-Only CPR training kiosk, which has equipped over 25,000 passengers with lifesaving skills since 2016. The airport also offers the BWI Marshall Airport Cardio Trail, two AHA-designated walking paths, providing passengers with a convenient way to stay active. Through these initiatives, MAA promotes a safer, healthier environment for the community and travelers.

“

The new #StrongerHearts health station at BWI Thurgood Marshall Airport demonstrates the enduring partnership between the American Heart Association and the airport to advance heart health and wellness, positively impacting travelers and the airport community.”

**TRACY BRAZELTON**

EXECUTIVE DIRECTOR, AMERICAN HEART ASSOCIATION, BALTIMORE & GREATER MARYLAND

**The BWI Trail** offers a 12-mile paved loop around the airport, making it a popular recreational spot for a peaceful ride, jog, or walk, with an occasional plane taking off or landing in the background. Much of the trail winds through wooded areas and local neighborhoods, providing a serene mix of natural scenery and activity. In 2024, MAA replaced over 3,000 feet of wooden boardwalks in environmentally sensitive areas to protect natural features throughout the trail.

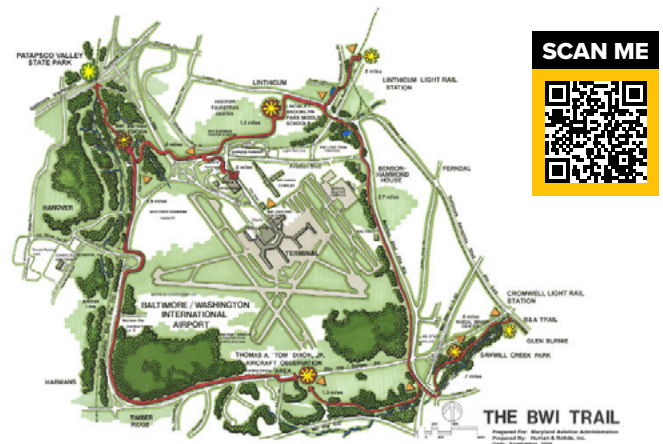

## ▶ BWI MARSHALL COMMUNITY GRANTS

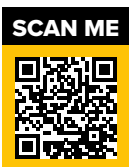

BWI Marshall supports its neighboring communities impacted by daily airport operations by offering transportation-related grants. These grants provide funding for requested projects that enhance local infrastructure such as sidewalk repairs and speed bumps. Grant applications are reviewed by a committee appointed by the Secretary of the Maryland Department of Transportation. In FY24, nearly \$85,000 was awarded for five community projects.

To find out if your neighborhood is eligible or to apply online, please visit [Community Grants](#).



► **COMMUNITY WITHIN THE COMMUNITY**

The MAA fosters a cohesive tenant community dedicated to ensuring an exceptional passenger experience at BWI Marshall Airport. This commitment is celebrated through the annual BWI Marshall Customer Service Awards, now in its third year, inspired by the concept of a unified “One BWI Marshall Community.”

**SCAN ME**



The event recognizes the outstanding service provided by tenants, acknowledging their efforts and fostering appreciation and camaraderie. This year, 373 nominations were submitted by colleagues, highlighting the dedication of those who go above and beyond to enhance the passenger experience. The event featured a moving rendition of “Maryland, Oh Maryland,” performed by the [TSA Choir](#), adding to the sense of pride and community.

*Celebrating Excellence in Service: Honoring the 2024 BWI Marshall Customer Service Awards recipients for their outstanding dedication to enhancing the passenger experience.*



**2024 CUSTOMER SERVICE AWARDS VIDEO**

**SCAN ME**



► **COMMUNITY PARTNERS PROGRAM**

BWI Marshall is proud to collaborate with local nonprofit organizations to support their missions and benefit to neighboring communities.

**SCAN ME**



Our Community Partners Program promotes charitable nonprofits by showcasing their important work throughout the terminal. Nonprofits from Maryland and Washington, D.C. are invited to apply to participate. The [application](#) can be completed online.

# COMMUNITY ENGAGEMENT

## ► BWI MARSHALL AIRCRAFT OBSERVATION PARK

The **BWI Aircraft *Observation Park*** is named for Thomas A. Dixon, Jr., a prominent aviation enthusiast and philanthropist who was passionate about making aviation both accessible and enjoyable for the community. This observation area offers playground facilities, picnic areas, and restrooms, allowing visitors to relax while enjoying the excitement of watching planes taking off and landing. It's a perfect spot to enjoy the thrill of aviation in a welcoming environment.



## ► MARYLAND FLEET WEEK

***Maryland Fleet Week*** brings thousands of people to our region for live performances, vendors, military and maritime exhibits, and educational demonstrations. Partnering with Baltimore County and the Glenn L. Martin Maryland Aviation Museum, Martin State Airport features a free open house and festival with military aircraft displays, musical entertainment, gift and souvenir booths, and food vendors.



Visitors enjoy aircraft on display and flyovers at Martin State Airport during Fleet Week.



## ► RESOURCES FOR INDIVIDUALS EXPERIENCING HOMELESSNESS

As a public place, BWI Marshall Airport has become a temporary refuge for some individuals experiencing homelessness. Through a comprehensive, community-driven strategy, the MAA ensures that these individuals have access to care and outreach services available within the State of Maryland while maintaining a safe and secure airport environment. Services provided include housing navigation and placement, mental health support, Naloxone/Narcan administration, and healthcare referrals, along with assistance in obtaining identification, securing employment, and accessing housing funding. Key partners in these efforts include the Maryland Department of Housing and Community Development, the Anne Arundel and Annapolis Coalition to End Homelessness, and the Anne Arundel Workforce Development Corporation. This collaborative, strategic use of resources promotes self-sufficiency for vulnerable populations and supports efforts to reduce homelessness.

## ► NATIONAL SECURITY AGENCY HONOR WALL

The National Security Agency (NSA) Honor Wall was unveiled at BWI Marshall in 2024 to recognize the vital contributions of NSA personnel to our national defense. Positioned in a prominent public space within the airport, the wall connects the public to the often-unseen efforts of those protecting the nation's security. A rotating digital display accompanies the wall, showcasing a series of declassified photos that highlight the agency's work over more than 70 years, offering passengers a glimpse into its history and mission.



MAA's Ricky Smith joins NSA leaders for a ribbon-cutting ceremony to celebrate the new NSA Honor Wall.



## ► HONORING AMERICA'S FALLEN FIREFIGHTERS

Each year, during [National Fallen Firefighters Memorial Weekend](#), America honors its fallen firefighters at the National Fire Academy in Emmitsburg, Maryland. BWI Marshall's Airport Rescue & Fire Fighting team plays a vital role in supporting the families who fly into BWI Marshall for this solemn occasion, warmly greeting them upon arrival and guiding them to a hospitality area where they wait for transportation to Emmitsburg.

# COMMUNITY ENGAGEMENT

## ▶ PATHFINDER VOLUNTEERS

The Pathfinders are BWI Marshall’s team of welcoming volunteers who assist travelers in navigating the airport. The Pathfinders are knowledgeable about the many transportation, tourism, and hospitality options near the airport and throughout the region. Our dedicated volunteers serve as ambassadors for our airport and our region, providing assistance to travelers from around the world. We are always looking for passionate individuals to join this extraordinary team. Volunteering as a Pathfinder is an opportunity to make a positive impact and be part of a vibrant and dynamic environment. [Volunteer at BWI.](#)



Pathfinders recruiting new volunteers to join our team.



Pathfinders enjoy making your trip easier!

## ▶ RESIDENTIAL SOUND INSULATION PROGRAM (RSIP)

Through the MAA’s participation in the Federal Aviation Administration’s (FAA) voluntary Code of Federal Regulations Part 150 Airport Noise Compatibility Program, eligible homes and schools receive sound insulation treatments to reduce the impact of airport operations on surrounding communities. This “good neighbor” program improves residents’ quality of life while supporting the airport’s long-term operational sustainability. To date, more than **700 homeowners and four schools** have participated in the BWI Marshall program since the 1980’s.



In FY24, the MAA received an FAA Airport Improvement Program grant and completed construction of Phase 1A of the RSIP program, which included sound insulation for **18 single-family homes** in the Glen Burnie/Severn area. The design phases for Phase 1B (**19 homes**) and Phase 2 (**203 multi-family units**) were also completed, with construction scheduled for FY25. For more information and to check program eligibility, visit [RSIP Information](#).

“ The entire process was seamless, with every aspect handled efficiently and without any issues. Communication throughout the project was thorough and consistent. We are extremely pleased with the results and grateful for their dedication. Thank you for a job well done.”

**SEVERN HOMEOWNER**  
RSIP PARTICIPANT



## ▶ WORKFORCE DEVELOPMENT



The partnership between BWI Marshall and Anne Arundel Workforce Development led to the creation of the ***Business Solutions Center***, a dynamic hub within the terminal that connects talent with businesses. The Center offers a range of services, including job postings, recruitment events, custom hiring solutions, training, specialized programs, and data resources to support employers. Serving thousands of job seekers each year, the Center strengthens local talent pools by attracting and securing diverse, qualified hires to meet the workforce needs of the airport and surrounding businesses.

**LOOKING AHEAD**, the MAA is planning the 75th anniversary of BWI Thurgood Marshall Airport next year. This milestone event will feature activities and events designed to honor the airport’s legacy and strengthen connections with our local communities. Through these celebrations, the MAA aims to recognize the invaluable support of our neighbors and highlight BWI’s ongoing role as a community partner and economic engine for Maryland.



# ENVIRONMENTAL SUSTAINABILITY



2024



Environmental stewardship is central to the MAA’s mission, promoting sustainable practices that balance operational efficiency with ecological and social responsibility. The **2024 Sustainability Plan**, developed by the MAA’s Office of Environmental Compliance and Sustainability, builds on our long-standing efforts to reduce greenhouse gas emissions, expand renewable energy use, and promote waste reduction. Guided by the Environmental Management System (EMS), these initiatives span BWI Marshall and Martin State Airports.

Sustainability at the MAA means addressing today’s needs without compromising future generations and carefully balancing environmental, economic, and societal factors. By integrating environmental stewardship into its planning and operations, the MAA supports Maryland’s climate action goals while ensuring long-term resilience and responsible growth.

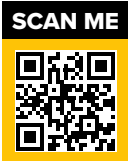

## ► CLIMATE ACTION INITIATIVES

The MAA is addressing climate change by reducing greenhouse gas emissions and adapting to climate risks. With Maryland’s Climate Solutions Now Act targeting a 60% emissions reduction by 2031 and “net zero” by 2045, the MAA is contributing through renewable energy and efficiency initiatives.

Currently, 40% of the MAA’s power comes from hydroelectric, solar, and wind sources. Additional climate efforts include solar panels on the parking garage, energy-efficient lighting, HVAC upgrades, pre-conditioned air units for aircraft, and electric buses. BWI Marshall offers 27 electric vehicle chargers, including 15 fast chargers that collectively offset more than 500 tons of CO<sub>2</sub> emissions since their installation. MAA has also saved energy by upgrading to LED lighting and enhancing HVAC systems at BWI and Martin State Airports. The MAA also supports low-carbon transportation such as Amtrak, MARC, and Light Rail.



*Electric buses drive sustainability at BWI Marshall.*



*Solar panels power a greener future.*

The MAA’s Decarbonization Roadmap is actively being developed, focusing on emissions reduction, renewable energy expansion, microgrid development, fleet electrification, and resilience against power outages. In November 2023, the MAA completed a Solar Siting Feasibility Study, evaluating over 70 sites for compatibility, feasibility, and business potential, and identifying the top-tier sites for future solar installation at both BWI Marshall and Martin State airports. Additionally, the MAA is preparing for climate-related threats with designated severe weather zones and integrated climate resilience measures in project planning.



► **CIRCULARITY**

The MAA is dedicated to circularity, reducing waste by recirculating resources, extending material lifecycles, and minimizing environmental impacts. Key highlights from FY2024:



Restaurants at BWI Marshall collected nearly 130 tons of food scraps for composting, nearly 50 tons of cooking oil to be refined into sustainable aviation fuel, and 72,000 oyster shells for restoration of oyster reefs in the Chesapeake Bay.



The MAA recycles cardboard, plastics, metals, and electronics and participates in the State Electronics Challenge, promoting responsible electronics management.



Six water filling stations were added during the BWI Marshall restroom improvements to reduce single-use plastic bottles.



Digital signature software saved the MAA nearly 40,000 sheets of paper.



The annual Earth Day Office Clean Out recycled nearly six tons of paper and donated over 400 binders to Baltimore County schools.

# ENVIRONMENTAL SUSTAINABILITY

The Chesapeake Bay, the largest estuary in the U.S., supports iconic Maryland species such as blue crabs, great blue herons, and oysters. Both MAA airports lie within the Bay’s watershed, and Martin State Airport lies directly on the water, making the MAA a vital participant in protecting the Bay’s health through efforts impacting water quality, land use, and wildlife.



As part of Maryland’s Chesapeake Watershed Agreement, the MAA aligns with Bay restoration goals outlined in the State of Maryland’s [Watershed Implementation Plan](#).

Efforts to meet Total Maximum Daily Load (TMDL) pollutant limits include stormwater treatment, street sweeping, and stream restoration. Additionally, a **122-acre forest conservation easement protects 84 acres of sensitive wetlands**. At BWI Marshall, water-saving restroom fixtures contribute to a **20% water savings**.



Additional Bay-friendly actions include trash cleanups, capturing and recycling aircraft deicing fluid, and oyster shell recovery. Chesapeake-themed artwork decorates the BWI Marshall terminal, and the MAA Green Team is exploring initiatives like rainwater harvesting and a pollinator garden.

In 2024, the FAA implemented new Performance Based Navigation (PBN) procedures for aircraft departing and arriving at Baltimore/Washington International Thurgood Marshall Airport. The new PBN procedures were specifically developed to reduce noise impacts in the neighborhoods surrounding BWI Marshall, while continuing to uphold safe and efficient air traffic operations.

These updated procedures mark a significant milestone in the comprehensive, detailed process aimed at addressing aircraft noise concerns raised by local communities.



BWI Marshall Airport remains committed to being a responsible community partner. We have been proactive in advocating for solutions that ensure the FAA addresses the noise concerns of our local residents. The newly implemented procedures are a testament to our dedication to balancing community needs with the delivery of safe, efficient, and reliable air travel. The creation of these new departure and arrival procedures was a collaborative effort, drawing on the expertise and input of community members, government leaders, industry experts, and the D.C. Metroplex BWI Community Roundtable. We extend our sincere gratitude to all partners and stakeholders for their commitment and hard work.

SCAN ME



For more information or to request a presentation, please visit [Airport Noise](#).

[The BWI Trail](#) around BWI Marshall Airport recently received several significant upgrades designed to enhance the user experience and support the local community. These upgrades include improved lighting, expanded access points, and new amenities such as rest areas and water bottle filling stations, which align with BWI's broader commitment to sustainability and accessibility.

SCAN ME



**LOOKING AHEAD**, in 2025, the MAA will complete its Decarbonization Roadmap Planning. This strategic initiative represents a commitment to pursuing and integrating eco-friendly practices and projects that emphasize responsible resource use. Through this comprehensive plan, the MAA will set the stage for sustainable development and reinforce its dedication to minimizing environmental impacts while ensuring a greener future.

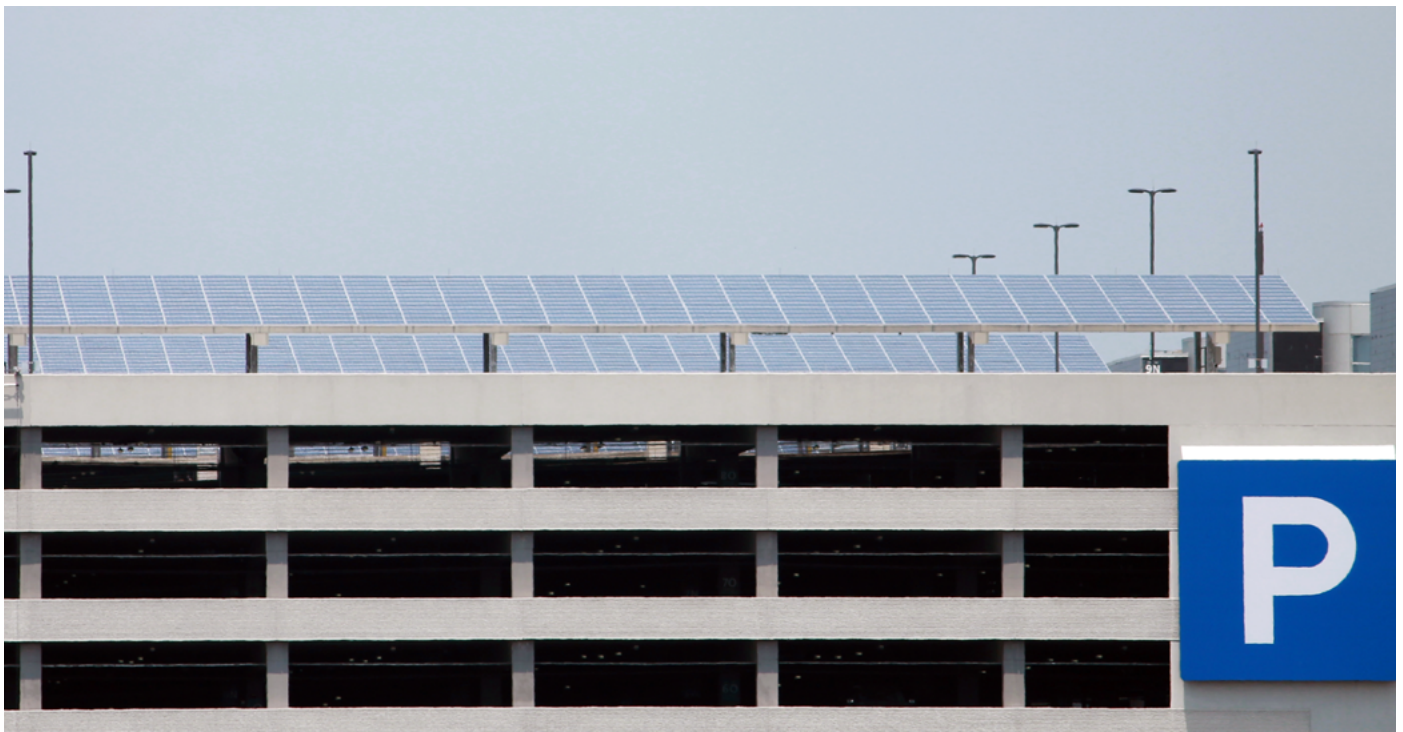

*Solar panels on BWI's garage roof harness clean energy.*

# YOUTH ENGAGEMENT

The Youth Engagement Pillar represents MAA’s commitment to investing in the next generation, offering young people opportunities to explore careers in aviation and beyond. Through programs like the Summer Youth Initiative, interactive tours, internships, and youth art exhibitions, we inspire students to envision a future in the industry while gaining hands-on experience and valuable mentorship. By partnering with educational institutions, industry leaders, and local organizations, we equip Maryland’s youth with the knowledge, skills, and connections they need to succeed, fostering a pipeline of future talent for aviation and related fields.

## ► SUMMER YOUTH INITIATIVE

In 2024, the MAA hosted the eighth annual Summer Youth Initiative, partnering with airport tenants, the BWI Business Partnership, the Community College of Baltimore County (CCBC), and local businesses to provide Baltimore City students with a week-long immersion in the airport’s dynamic work environment. Through tours and hands-on experiences, students explore the airfield, observe operations from the flight tower, visit the Fire & Rescue Department, and interact with TSA and Customs & Border Protection teams, including K-9 demonstrations. They also have opportunities to step inside aircraft cockpits, tour a regional airport, visit Amazon’s distribution center, and explore CCBC to learn about educational opportunities.



*Future aviators exploring BWI Marshall’s airfield.*



*Students get an inside look at airport security.*

SCAN ME



By interacting with airport employees across various roles, students gain valuable insights into the wide range of career opportunities within the aviation industry at one of the region’s largest employment hubs. This experience teaches the importance of education, hard work, and discipline, inspiring students to consider careers in aviation and related fields. Through these partnerships, the MAA and local businesses support the community by investing in the next generation, empowering students with knowledge and connections that will benefit them in the future. [Summer Youth Initiative](#)

## ► INTERNSHIP PROGRAM

The MAA offers a hands-on internship program for college students that provides valuable experience in aviation, airport management and transportation. Open to students in fields of engineering, IT, communications, and business, the internships allow participants to work on real projects and gain industry insights. Applicants must have a GPA of 2.5 or higher, pass pre-employment screenings, and submit a resume, personal statement, and transcripts. This is an exceptional opportunity to collaborate with a dynamic team and find out if they want to pursue a career in these fields. [MAA Internships](#)



SCAN ME



*Talented interns are future MAA leaders.*





Girl Scouts meet the K-9 team.

## ▶ YOUTH TOURS

The MAA is dedicated to introducing youth to the aviation industry through interactive experiences at BWI Marshall and Martin State Airports. In 2024, BWI Marshall hosted tours for Girl Scouts and members of WTS, STEM students with Airlines for America, in collaboration with tenants and contractors. These tours provided students with real-world exposure to aviation operations and mentorship, helping to cultivate the future workforce and ensure a pipeline of talent for the industry.

The MAA also participated in National Engineers Week for the first time, hosting an Aviation Day event that included an airfield tour that showcased key aspects of operations and infrastructure. Students engaged with the MAA leadership team and engineers from various disciplines to learn about their education and career paths. These experiences aim to inspire students to consider careers in engineering and aviation.



Celebrating young talent at BWI Marshall.

## ▶ YOUTH ART

BWI Marshall Airport proudly showcases artwork from K-12 students across Maryland in its Observation Gallery. In partnership with the Maryland Art Education Association, this exhibit features talented students from all 23 counties and Baltimore City, highlighting the exceptional quality of art education throughout the state. MAA celebrates student creativity and underscores the vital role of art in Maryland's education system. [Youth Art Exhibits](#)

**LOOKING AHEAD** to 2025, the MAA will launch a youth contest in partnership with The Congressional Foundation and develop a high school apprenticeship program to provide students with career pathways in the aviation industry.



Airlines for America (A4A) holds first girls STEM day in partnership with MAA.



# MILITARY SUPPORT

The MAA proudly supports our nation’s defense by honoring and assisting active-duty service members, their family members, and veterans. BWI Marshall is renowned for its substantial military support, serving as a hub for military personnel, thanks to the presence of the Air Mobility Command, in addition to the airport’s proximity to major military installations. Each year, tens of thousands of military members, their families, and veterans benefit from specialized services facilitated through partnerships with the USO, Operation Welcome Home, and the Honor Flight Network. These initiatives reflect the MAA’s commitment to those who serve.

## ► AIR MOBILITY COMMAND

The U.S. Air Force is responsible for our nation’s defense transportation system and its Air Mobility Command provides rapid global mobility and sustainment for the U.S. Armed Forces. BWI Marshall is one of only two AMC gateway airports in the United States, serving military passengers and their families from all service branches traveling to and from duty stations around the world.



## ► USO INTERNATIONAL GATEWAY LOUNGE

BWI Marshall hosts one of the largest USO airport facilities in the world, providing comfort to more than 80,000 military personnel and their families each year. Friendly and well-trained USO volunteers are dedicated to assisting military passengers during their travels across the globe. Complimentary services include baggage storage, a snack bar, comfortable seating, a sleeping room with wake-up calls, the Bob Hope Legacy Reading Program, a children’s play area and nursery, as well as support for families of the fallen. [USO Lounge](#)

## ► DIGNIFIED TRANSFERS

To honor those who have given their lives in service to our country, BWI Marshall conducts a solemn, dignified transfer of the service person’s remains, attended by the deceased’s family. The ceremony includes a water salute by fire-fighting vehicles on the taxiway. BWI Marshall’s dedicated team has coordinated nearly 250 dignified transfers since 2014.



## ► OPERATION WELCOME HOME

Flights carrying service members returning from overseas are often greeted at BWI Marshall by a cheering crowd, showering them with gratitude and appreciation.

Since 2007, [Operation Welcome Home](#) has coordinated the goodwill of the community, bringing together residents, corporations, government agencies, youth groups, and civic and religious organizations to show their support.

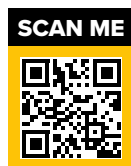



## ▶ HONOR FLIGHTS

Each year, more than 10,000 veterans are welcomed by volunteers at BWI Marshall with cheers, signs and patriotic music as they arrive to visit the war memorials in Washington, D.C. and Arlington National Cemetery. Since its inception in 2005, this program has honored more than 300,000 veterans. The [Honor Flight Network](#) is committed to providing these heroes with a meaningful experience of honor and closure. BWI Marshall supports this mission by providing logistical assistance and welcoming each flight with a ceremonial water salute from fire-fighting vehicles.



*U.S. Naval Academy midshipmen honor arriving veterans.*



## ▶ WREATHS ACROSS AMERICA AT FRIENDSHIP CEMETERY

BWI Marshall Airport honors veterans in many ways. One is by participating in the annual [Wreaths Across America](#) Day. During this event, members of the BWI Marshall community place wreaths on the graves of veterans buried at Friendship Cemetery, which is located on airport grounds. This symbolic act of remembrance serves to honor and pay respect to those who served in the military, reflecting the airport's commitment to the local community and its veterans. The event is part of a nationwide movement to remember, honor, and teach about the sacrifices made by service members.

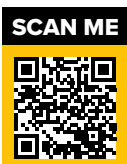

**LOOKING AHEAD** to 2025, we plan to deepen our collaboration with military support organizations to further honor our troops.



*Honoring veterans at Friendship Cemetery.*

# FINANCIALS

## THE MARYLAND AVIATION ADMINISTRATION STATEMENT OF REVENUE

FISCAL YEAR ENDING - JUNE 30, 2024 AND 2023

	FY 2024	FY 2023	DIFFERENCE	% CHANGE
<b>BWI OPERATING REVENUE</b>				
FLIGHT ACTIVITIES	\$72,501,868	\$72,862,829	(\$360,961)	-0.5%
RENTS & USER FEES	\$94,020,668	\$82,685,626	\$11,335,042	13.7%
PUBLIC PARKING	\$82,938,510	\$79,827,020	\$3,111,490	3.9%
RENTAL CARS	\$17,061,491	\$18,165,450	(\$1,103,959)	-6.1%
RETAIL, FOOD & BEVERAGE	\$21,078,984	\$18,223,965	\$2,855,019	15.7%
OTHER PASSENGER CONCESSIONS	\$11,559,896	\$8,971,068	\$2,588,828	28.9%
NON-PASSENGER CONCESSIONS	\$5,620,705	\$5,060,339	\$560,366	11.1%
OTHER REVENUE	\$5,463,163	\$13,432,495	(\$7,969,332)	-59.3%
<b>TOTAL BWI OPERATING REVENUE</b>	<b>\$310,245,285</b>	<b>\$299,228,792</b>	<b>\$11,016,493</b>	<b>3.7%</b>
<b>MTN OPERATING REVENUE</b>	<b>\$11,138,904</b>	<b>\$12,241,649</b>	<b>(\$1,102,745)</b>	<b>-9.0%</b>
<b>TOTAL MAA OPERATING REVENUE</b>	<b>\$321,384,189</b>	<b>\$311,470,441</b>	<b>\$9,913,748</b>	<b>3.2%</b>
<b>REVENUE BOND DEBT SERVICE <sup>1</sup></b>	<b>(\$28,335,061)</b>	<b>(\$26,879,261)</b>	<b>(\$1,455,800)</b>	<b>5.4%</b>
<b>MAA OPERATING REVENUE TO THE TTF</b>	<b>\$293,049,128</b>	<b>\$284,591,180</b>	<b>\$8,457,948</b>	<b>3.0%</b>
<b>OTHER REVENUES TO THE TTF <sup>2</sup></b>				
FEDERAL STIMULUS REIMBURSEMENTS	\$0	\$109,740	(\$109,740)	-100.0%
CAPITAL REIMBURSEMENT TO TTF	\$5,868,507	\$0	\$5,868,507	-
<b>TOTAL OTHER REVENUES TO THE TTF</b>	<b>\$5,868,507</b>	<b>\$109,740</b>	<b>\$5,758,767</b>	<b>5247.6%</b>
<b>TOTAL TTF REVENUE</b>	<b>\$298,917,634</b>	<b>\$284,700,920</b>	<b>\$14,216,715</b>	<b>5.0%</b>
<b>NON-OPERATING REVENUE</b>				
CUSTOMER FACILITY CHARGES	\$12,716,994	\$9,429,658	\$3,287,335	34.9%
PASSENGER FACILITY CHARGES	\$50,901,274	\$45,520,385	\$5,380,889	11.8%
INTEREST INCOME <sup>3</sup>	\$12,371,983	\$8,909,777	\$3,462,206	38.9%
<b>TOTAL NON-OPERATING REVENUE</b>	<b>\$75,990,251</b>	<b>\$63,859,820</b>	<b>\$12,130,431</b>	<b>19.0%</b>
<b>TOTAL MAA REVENUE PRIOR TO DEBT</b>	<b>\$403,242,946</b>	<b>\$375,440,001</b>	<b>\$27,802,945</b>	<b>7.4%</b>



- 1 2021A Revenue Bonds refunded Parking and MEDCO debt. Fiscal year debt paid monthly to pay debt annually each August and February paid to Trustee for future debt payments and does not reflect actual Bond Year payments. Interest Earned has lowered FY24 installment payment amount.
- 2 FY23 includes CRRSAA Concession Relief Funds for consulting expenses \$56,904 and ARPA Martin Sewer reimbursement \$52,836. FY24 Includes reimbursement of PFC Eligible Capital Expenses advanced by TTF
- 3 Interest income captures revenue bonds beginning FY23. Gross of transfers. Excludes \$1M of investment maturity interest.

## THE MARYLAND AVIATION ADMINISTRATION

### BALTIMORE/WASHINGTON INTERNATIONAL THURGOOD MARSHALL AIRPORT AND MARTIN STATE AIRPORT COMPARATIVE STATEMENT OF REVENUE, EXPENSE AND INCOME (THOUSANDS)

	FY 2024	FY 2023	DIFFERENCE	% CHANGE
<b>TTF REVENUE AND EXPENSE</b>				
TTF OPERATING REVENUE	\$293,049	\$284,591	\$8,458	3.0%
TTF REVENUE - FEDERAL	\$5,869	\$110	\$5,759	5247.6%
MAA OPERATING EXPENSE	\$239,526	\$224,782	\$14,744	6.6%
<b>TTF SURPLUS/(DEFICIT)</b>	<b>\$59,392</b>	<b>\$59,919</b>	<b>(\$527)</b>	<b>-0.9%</b>
<b>NON-TTF</b>				
NON-OPERATING REVENUE	\$75,990	\$63,860	\$12,130	19.0%
NON-TTF DEBT SERVICE	\$32,620	\$33,190	(\$570)	-1.7%
<b>NON-TTF SURPLUS/(DEFICIT)</b>	<b>\$43,371</b>	<b>\$30,670</b>	<b>\$12,700</b>	<b>41.4%</b>
<b>TOTAL MAA SURPLUS/(DEFICIT)</b>	<b>\$102,762</b>	<b>\$90,589</b>	<b>\$12,173</b>	<b>13.4%</b>
<b>CAPITAL PROGRAM EXPENDITURES</b>	<b>\$279,091</b>	<b>\$180,141</b>	<b>\$98,950</b>	<b>54.9%</b>
<b>ENPLANEMENTS</b>	<b>13,496,059</b>	<b>12,365,276</b>	<b>1,130,783</b>	<b>9.1%</b>

# FINANCIAL SUMMARY

## ▶ **FY24 PROFIT AND LOSS STATEMENT**

During FY24, the MAA's financial performance showed strong growth. The MAA's TTF Operating Revenues of \$293 million increased by \$8.5 million over FY23. This revenue growth was driven by increased terminal rates and charges, increased ground transportation fees, increases in parkers using our facilities, and strong food, beverage, and retail revenues. The MAA's FY24 Operating Expenses of \$239 million increased by 6% over FY23. Operating costs increased because of higher salaries and wages, three major snow events, and contractual services such as janitorial and security. This resulted in an MAA TTF Operating Surplus of \$59 million.

## ▶ **FEDERAL FUNDING STRATEGY**

The passage of the Bipartisan Infrastructure Law (BIL) in FY22 made additional federal funding available to the MAA to improve airport infrastructure over the next several years. The MAA has been able to program \$170 million in an anticipated Airport Improvement Program (AIP) from the federal funding to construct critical airfield and terminal improvement projects at BWI Marshall and Martin. Through FY26, the MAA entitlement increases to at least \$25 million for BWI and \$800,000 for Martin. In addition, the MAA has been aggressive in submitting applications to compete for discretionary grant opportunities that have been expanded under the passage of BIL. In FY24, the MAA was awarded three discretionary grants totaling approximately \$40 million in federal funding for DX/DY Apron Reconstruction, Martin State Air Traffic Control Tower Replacement, and Passenger Boarding Bridge Replacements.

## ▶ **REVENUE BOND STRUCTURE**

MDOT issues Special Transportation Project Revenue Bonds on behalf of the MAA. In July 2021, MDOT issued the MAA's second series (2021B) for \$200 million in funding, which also received investment-grade ratings and favorable interest rates. This funding was used for the Terminal A/B Connector and Baggage Handling System Project. MAA closed on the second series of revenue bonds in November 2024 for \$219 million to fund the remaining costs of the project.

# THE MAA LEADERSHIP TEAM



**RICKY SMITH**

Executive Director/CEO



**KEIVA RODRIQUES**

Chief Operating Officer



**DIANA LÉON BROWN**

Chief of Staff



**RENÉE LARKINS**

Chief Executive Assistant to the Executive Director



**STACI GORDEN**

Special Assistant to the Executive Director



**ANNETTE FISHER**

Chief, Marketing & Air Service Development



**HAROLD FOWLER**

Chief, Martin State Airport Operations & Maintenance



**RACHEL GOODMAN**

Chief, Airport Technology & Innovation



**SHANAE MURRAY**

Chief, Admin & Performance Management



**WAYNE PENNELL**

Chief, BWI Marshall Operations & Maintenance



**PAUL SHANK**

Chief, Planning & Engineering



**ASHISH SOLANKI**

Director, Regional Aviation Assistance



**TANYA WOJTULEWICZ**

Chief, Business Development & Management



# THE MARYLAND AVIATION COMMISSION

The Maryland Aviation Commission establishes the policies by which the airport operates and consists of 13 voting members. Twelve members are appointed by the Governor with the advice and consent of the Senate, with the Secretary of the Maryland Department of Transportation serving as Chair and the 13th voting member and the Secretary of Commerce serving as a nonvoting ex-officio member.

**Mr. Paul Wiedefeld, Chairman**  
Secretary, Maryland Department of Transportation

**Mr. Ned Carey**

**Mr. Jesse Chancellor**

**Ms. T. Chineta K. Davis**

**Ms. Lisa Ellis**

**Mr. Drew Hawkins**

**Mr. Jose Morales**

**Mr. Raymond C. Nichols Sr.**

**Ms. Mary Reese**

**Dr. Cedric Sims**

**Mr. David L. Winstead**

**Dr. Zafar Zafari**

***Vacant***

**Mr. Kevin Anderson, ex officio**  
Secretary, Maryland Department of Commerce

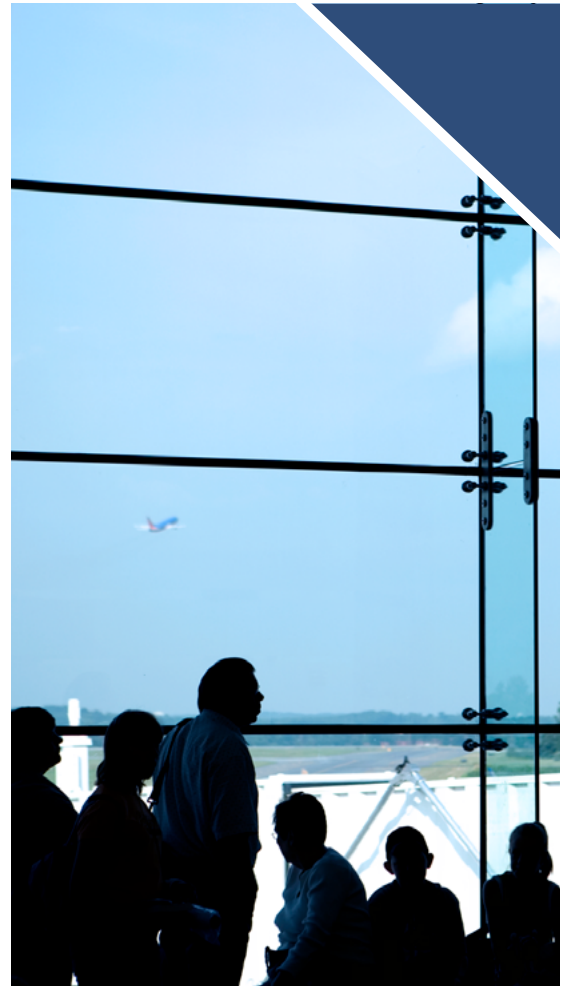

# PROFESSIONAL AFFILIATIONS

Airport Ground Transportation Association ▶ Airport Minority Advisory Council ▶ American Association of Airport Executives ▶ American Bar Association ▶ American Contract Compliance Association ▶ American Institute of Architects ▶ American Society of Civil Engineers ▶ American Society for Industrial Security ▶ Anne Arundel Chamber ▶ Ann Arrundell Historical Society ▶ Association for Talent Development ▶ Association of Airport Internal Auditors Association of Change Management ▶ Association of Energy Engineers ▶ Association of Government Accountants ▶ ASIS International ▶ Baltimore City Chamber of Commerce ▶ Baltimore County Chamber of Commerce ▶ Baltimore Public Relations Council ▶ BWI Business Partnership ▶ BWI Rotary Club ▶ Capital Region Minority Supplier ▶ Central Maryland Chamber ▶ Chesapeake Gateway Chamber of Commerce ▶ Chesapeake Human Resources Association ▶ Chesapeake Region Safety Council ▶ Client Protection Fund of the Bar of Maryland ▶ Conference of Minority Transportation Officials ▶ Construction Management Association of America ▶ Destination DC ▶ District of Columbia Bar ▶ District of Columbia Chamber of Commerce ▶ Experimental Aircraft Association ▶ FBI Baltimore Citizens Academy Alumni Association ▶ FBI National Academy Associates ▶ Frederick County Chamber of Commerce ▶ Gaithersburg-Germantown Chamber of Commerce ▶ Global Business Travel Association ▶ Greater Baltimore Committee ▶ Greater Bethesda Chamber of Commerce ▶ Greater Crofton Chamber of Commerce ▶ Greater Severna Park & Arnold Chamber of Commerce ▶ Greater Washington Board of Trade ▶ Harford County Chamber of Commerce ▶ Howard County Chamber of Commerce ▶ Howard County Human Resources Society ▶ ICOR ▶ Innovating Commerce Serving Communities ▶ Institute of Certified Management Accountants ▶ Institute of Internal Auditors ▶ International Association of Black Professional Fire Fighters ▶ International Aviation Club ▶ International Code Council ▶ International Council of Air Shows ▶ International Council of Shopping Centers ▶ Leadership Anne Arundel ▶ Leadership Maryland ▶ Maryland Airport Manager's Association ▶ Maryland Association of Certified Public Accountants ▶ Maryland Association of Engineers ▶ Maryland Aviation Council ▶ Maryland Chamber of Commerce ▶ Maryland Council of Fire & Rescue Academies ▶ Maryland Government Finance Officers Association ▶ Maryland Hispanic Chamber of Commerce ▶ Maryland Public Purchasing Association ▶ Maryland State Bar Association ▶ Maryland Tourism Coalition ▶ Mid-Atlantic Aviation Partnership ▶ Montgomery County Chamber of Commerce ▶ National Air Transportation Association ▶ National Association of Black Journalists ▶ National Association of Fire Investigators ▶ National Association of Fleet Administrators ▶ National Association of State Aviation Officials ▶ National Business Aviation Association ▶ National Fire Protection Association ▶ National Fire Sprinkler Association ▶ National Forum for Black Public Administrators ▶ National Institute of Governmental Purchasing ▶ National Parking Association ▶ National Public Purchasing Association ▶ National Safety Council ▶ National Society of Professional Engineers ▶ Northern Anne Arundel Chamber of Commerce ▶ Organization Development Network ▶ Prince George's County Chamber of Commerce ▶ Project Management Institute ▶ Public Sector HR Association ▶ Reginald F. Lewis Museum ▶ Safety Council of Maryland ▶ Society for Human Resource Management ▶ The Congressional Award Foundation ▶ The Economic Club of Washington, D.C. ▶ The Leadership ▶ Toastmasters International ▶ United States Contract Weather Observing Association ▶ United States District of Columbia ▶ United States District Court for the District of Maryland ▶ Virginia Board of Accountancy ▶ Visit Baltimore ▶ WTS International ▶ World Trade Center Institute



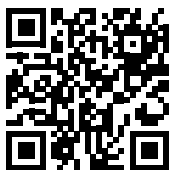

- [MARYLANDAVIATION.COM](https://www.MARYLANDAVIATION.COM)
- [BWIAIRPORT.COM](https://www.BWIAIRPORT.COM)
- [MARTINSTATEAIRPORT.COM](https://www.MARTINSTATEAIRPORT.COM)

